

## Satin Black

### TC10 series Twin Connector Assembly Self Trimming Cover

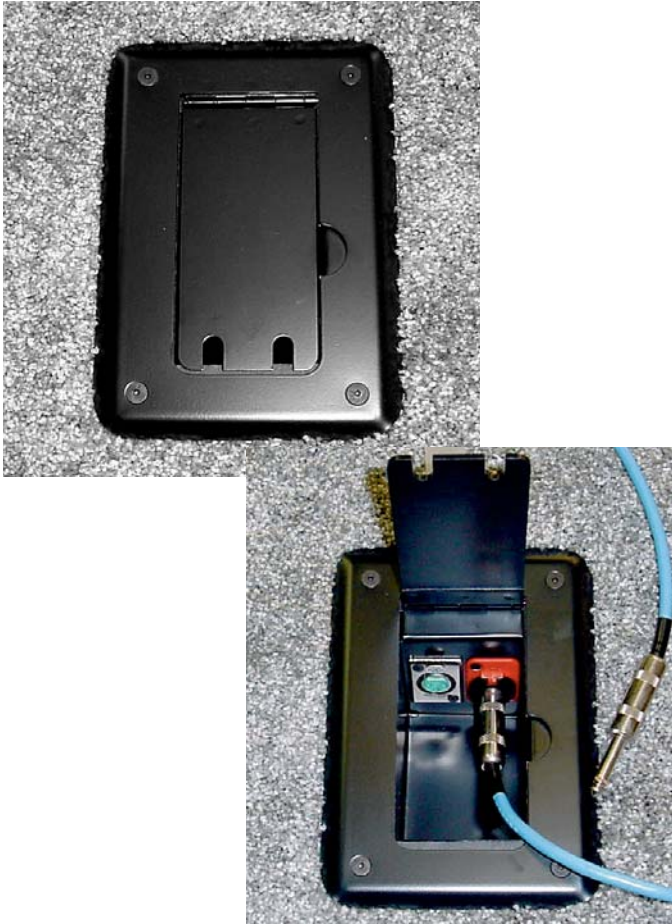

### BBTC Backbox

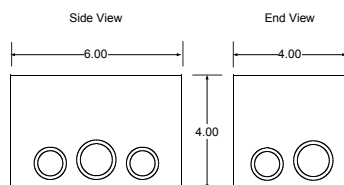

### A & E Specifications

The TC10/11 Twin Connector Assembly shall consist of a Door/Cover, a basket and Connector Mounting Panel Insert. Door/Cover shall be of 11 gauge steel with ceramic plastic satin black finish or, 11 gauge hand finished solid brass (not plated), measuring 7"L x 5"W, with radiused corners on an integral self trimming ring that mounts virtually flush with the surrounding surface, and shall be secured with security socket head screws. Basket shall be of 16 gauge steel and shall be 4.5"L x 2.5"W x 2.5"D. Basket shall mount on manufacturer's backbox (BBTC). Connector Mounting Panel shall be of 16 gauge steel and shall accommodate \_\_\_\_\_ (specify quantity and type) \_\_\_\_\_ connectors and shall be removable for installation and service without disassembling Door/Cover or Basket. Twin Connector Assembly shall be Mystery Electronics TC10/11.

The BBTC backbox shall be heavy gauge cold rolled steel, shall measure 6"L x 4"W x 4"D nominal dimension, shall be Underwriters Laboratory listed and conform to N.E.M.A. standards. Backbox shall have 10 each combination knock outs (1/2" to 1" trade size) spaced uniformly on the sides and ends. Backbox shall have disposable heavy gauge metal cover, attached with screws, for protection during installation rough-in. The cover mounting flange shall have 4 holes tapped for 8/32 screws to accommodate mounting of Mystery Electronics TC series. Backbox shall be coated overall with gray urethane. Backbox shall be Mystery Electronics BBTC.

## Satin Hand Finished Brass

### TC11 series Twin Connector Assembly Self Trimming Cover

- **Our most compact floor box**
- **Comes complete with choice of prepunched Duoline® connector insert panel. Accepts industry standard connectors or optional features. See Duoline® Inserts Data Sheet for details.**
- **Mounts on BBTC backbox**
- **Durable high tech finish looks "smart"-endures wear longest.**
- **Two cable slots allow hinged door to be closed while in use.**
- **Installs on carpeted or hard surface floors. No tangled wires underfoot.**
- **Installs on stages, walls, building column fascia, conference room tables, courtroom furniture and floors.**
- **Narrow profile allows concealed connectors in tight spaces.**

For floor mounted connections where space is at a premium, the TC10/11 offers small size, while retaining the full advantages of a flush mounted floor box. Self-trimming cover mounts virtually flush with the floor, concealing and protecting connectors while allowing easy access. Eliminates costly warranty callbacks caused by broken release tabs and dirt or debris collecting in exposed connectors. Shallow depth accommodates many wall and furniture mounted applications. Mounting hardware is provided for quick and easy installation, complete with high security cover mounting screws and hex type wrench.

### Dimensional Data (Nominal)

TC10/11

Door/Cover: 7"L x 5"W

Basket: 4.5"L x 2.5"W x 2.5"D

Insert: 2.8"L x 2.3"W (overall)

### BBTC Backbox

6"L x 4"W x 4"D equipped with 1/2", 3/4" combination and 3/4", 1" combination knockouts

**MYSTERY ELECTRONICS**

Mystery Electronics, LLC  
6438 Morton Road  
Greenbrier, TN 37073  
800 798 2256 sales  
615 643 8460 voice  
615 643 8464 fax

[www.mysteryelectronics.com](http://www.mysteryelectronics.com)